

**#23504**

## Источник бесперебойного питания (ИБП), 1000 ВА

Надежный ИБП мощностью 1000 ВА с резервным питанием от батареи и с 4 розетками. Идеально подходит для питания и защиты ваших электронных устройств

### Key features

- Надежный ИБП мощностью 1000 ВА со встроенным аккумулятором
- Обеспечивает временную подачу электричества во время отключения энергии; предотвращает потерю данных и повреждение оборудования
- 4 розетки со встроенным аккумулятором и защитой от перепадов напряжения для подключения компьютера, периферийных устройств, сетевого оборудования, телевизора с плоским экраном, автоматизированных систем для дома или аварийной сигнализации
- Разъемы с защитой от выбросов напряжения для предотвращения повреждений от скачков, падений и колебаний напряжения
- USB-порт и ПО для контроля статуса ИБП, отправки уведомлений и автоматического завершения работы компьютера
- Функция автоматической регулировки напряжения обеспечивает стабильное выходное напряжение 230 В



### What's in the box

- Блок ИБП
- Кабель USB
- Руководство пользователя

### System requirements

- Подключение к заземленной настенной розетке
- Для ПО: Windows 10, 8 или 7, порт USB
- Необходимо 155 Мбайт свободного дискового пространства
- Последнюю версию ПО можно загрузить с сайта:
- [www.trust.com/23504/driver](http://www.trust.com/23504/driver)

**1000<sup>VA</sup>**  
BATTERY



4X POWER  
OUTLETS



SURGE  
PROTECTION



USB  
MONITORING



## In Safe Hands

You can rest easy, knowing that the Trust Paxxon 1000VA is keeping an eye out for your devices. The reliable UPS is an ideal secondary power source to your electronics, keeping them running temporarily during power grid blackouts, and protecting them from power surge damage.

## Protect Your Devices

With 4 standard wall power outlets, the Paxxon is equipped to protect whatever device or peripheral is connected to it: computer, TV, gaming console, home automation or alarm system, router or modem, or other wall-powered devices. You can connect devices up to a maximum total of 600 Watts or 1000VA.



## Safe Shutdown

During a blackout, the UPS' large battery generously covers the power needs of an average PC setup. With 2 minutes of runtime\* to save your work and safely shut the system down, the quality of your files and equipment is guaranteed to be maintained.\* At 450W capacity load

## Extra Options

Paxxon's USB connection and downloadable PC software enable you to program the UPS to execute an automated shutdown, in case of a power outage. If you'd rather save your work and power off manually, the software allows you to set custom visible and audible signals to alert you, as well as monitor the power supply status at all times.

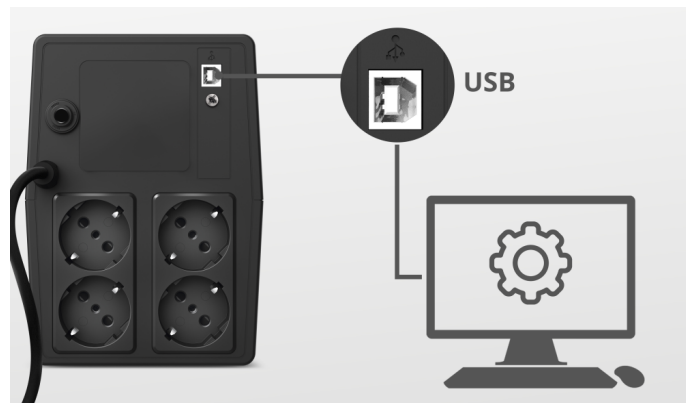



### Stable Output

Thanks to the AVR function, the UPS will maintain a stable output voltage. In the event of power surges or spikes, your equipment is in safe hands. So safe, that we're offering an extended warranty of up to € 20.000 on connected equipment.\*\*\*\* Check conditions on [trust.com](https://www.trust.com)

## GENERAL

Height of main product (in mm)	320 mm	Width of main product (in mm)	182 mm
Depth of main product (in mm)	130 mm	Total weight	7800 g
Weight of main unit	7800 g		

## OUTPUT

Output power capacity (VA)	1000 W	Output power capacity (W)	600 W
Output voltage range	Nominal voltage	Frequency response UPS	50Hz +/- 1Hz
Waveform type	Simulated sine wave		

## PROTECTION

Protections	Child safety shutter, current-recoil, over-charge, over-cranking, over-current, over-discharge, over-heat, over-load, short-circuit	Auto Voltage Regulation	True
RFI-filter	False	Surge protected AC outlets	True
Surge protected phone line	False		

## POWER

Number of batteries	2	Battery composition (Alkaline, Li-ion, etc.)	Lead Acid
Power inlet connection	Schuko (Type F)	Power outlet socket type	Schuko
Battery capacity (Ah)	7 Ah	Battery voltage (V)	12 V
Number of power outlets	4	Battery charge time (hours)	8 hours
100% capacity runtime (seconds)	28 seconds	50% capacity runtime (minutes)	5 minutes

## FEATURES

Management function (USB)	True	USB connection	True
Status display	False	Audible alarm	True
Software	True		

## INPUT

Nominal input voltage	220-240Vac	Operating voltage range	162-290Vac
-----------------------	------------	-------------------------	------------

## CONNECTIVITY

Cables included	USB-B to USB-A	Cable detachable	False
Cable length main cable	140 cm		

CONTROL

Indicators

Activity, Battery, Battery  
empty, Overload, Power



PRODUCT VISUAL 1



PRODUCT PICTORIAL 1



PRODUCT PICTORIAL 2



PRODUCT PICTORIAL 3

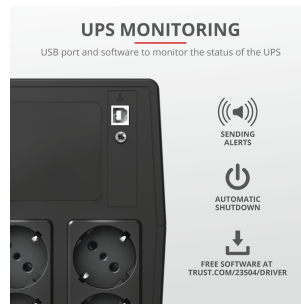

PRODUCT PICTORIAL 4

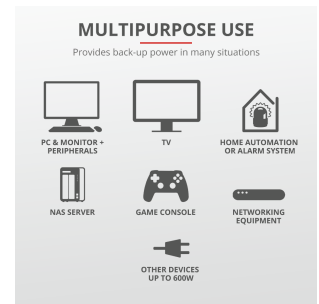

PRODUCT PICTORIAL 5

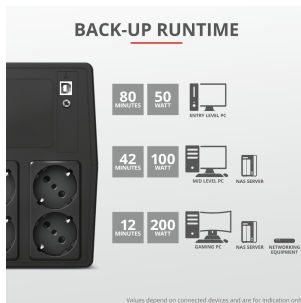

PRODUCT PICTORIAL 6



PRODUCT ESHOT 1



LIFESTYLE VISUAL 1



PRODUCT VISUAL 2



PRODUCT FRONT 1



PRODUCT BACK 1