

## PRODUCT USE GUIDE



www.marvo-tech.com

### QUICK INSTALLATION GUIDE

# CM409

## 4-in-1 GAMING STARTER KIT

### TECH SPECS

#### Keyboard Specs:

Keys: 104  
Switch type: membrane  
Switch rating: 10 million presses  
Key route: 4.0 ± 0.3 mm  
Operating force: 55 ± 7g  
Backlight: mixed colors (Rainbow)  
Interface: USB 2.0  
Cable length: 1.5 m  
Size: 435 x 128 x 35 mm

#### Mouse Specs:

Sensor: Optical  
DPI: 800-1600-2400-3200  
Buttons: 6  
Switch rating: 3 million clicks  
Backlight: 7 colors  
Interface: USB 2.0  
Cable length: 1.5 m

### QUICK INSTALLATION GUIDE

#### Headset Specs:

Sound: stereo  
Frequency response: 20 Hz - 20 KHz  
Speaker size: 40 mm  
Speaker sensitivity: 105 dB ± 3 dB  
Speaker impedance: 32 Ω  
Microphone type: omnidirectional  
Microphone size: 6x5 mm  
Microphone sensitivity: -42 dB ± 3 dB  
Connectors: 3.5 mm jack x 2  
Cable length: 1.8 m

#### Mousepad Specs:

Ideally suited for high sensitivity mouse settings  
The anti-sweating design prevents edge warping  
Anti-skid rubber base  
Size: 287 x 244 x 3 mm

### PRODUCT PRESENTATION

#### 1. FEATURES

- Advanced anti-ghosting: game confident with 19-key rollover support for enhanced commands readings.
- Waterproof: keyboard designed to quickly drain the liquids in case of accidental spillage.
- Ergonomics: streamlined mouse shape accommodates various grip styles.
- On-the-fly: quick 4-step DPI selection button.
- Big sound: closed, over-ear headset design for powerful bass sounds.
- High-quality mat: optimized tracking accuracy for both laser and optical sensors.
- Cool boks: multi-color backlight, see-through character lighting.

### QUICK INSTALLATION GUIDE

#### 2. SYSTEM REQUIREMENTS

PC system or compatible with the installed sound card, two USB ports available; Windows 7 or newer operating system.

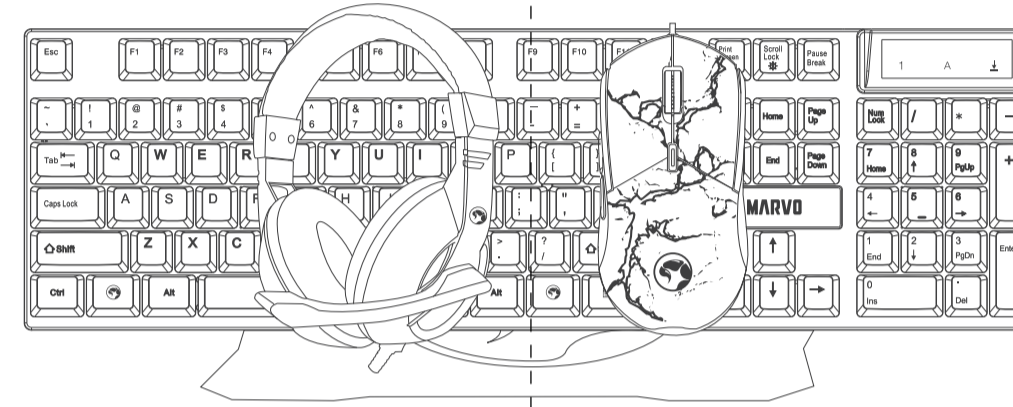

### QUICK INSTALLATION GUIDE

#### SAFETY NOTES

- To prevent possible hearing problems, do not use the headphones at high volume for long periods of time.
- Keep the equipment dry. Keep away from precipitation, humidity, all types of liquids and condensation.
- Do not use the product with wet hands.
- Do not use or store the equipment in dusty or dirty areas.
- Do not store the equipment under high-temperature or low-temperature conditions (this may damage it).
- Do not drop, knock or shake the equipment (use may result in breakage).

#### INSTALLATION

Connect the keyboard and mouse to the available USB ports on your computer. If the peripherals are used for the first time wait approx. 15 seconds to install the generic driver.

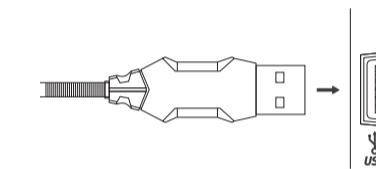

www.marvo-tech.com

### QUICK INSTALLATION GUIDE

Each headphone audio jack is colored different (green for headphones, pink for microphone) or has an icon on it. Connect each jack to the matching input on the sound card.

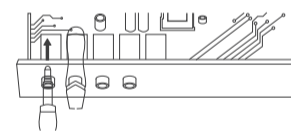

NOTE:  
This kit does not have a specialized driver and does not require one for proper operation and functionality.

#### USE

Configuring the keyboard and using the special functions is done by using the various key combinations detailed below.

### QUICK INSTALLATION GUIDE

#### Multimedia and office functions

	open media player
	decrease audio volume
	increase audio volume
	mute
	stop media file playback
	previous track
	play / pause
	next track
	open the e-mail client
	open the Internet browser
	lock
	open the Calculator

#### Key-lock functions

+ : enable / disable the Windows key

#### Backlight control functions

Press the LED key to enable/disable the backlight.

: increase brightness

: decrease brightness

### QUICK INSTALLATION GUIDE

#### TROUBLESHOOTING

In case of incorrect operation follow the steps below:

- Check the integrity of the connectors;
  - Check the connection to your computer;
  - Check your computer settings;
  - Disconnect and reconnect the equipment; restart the computer.
- If the problem persists, please contact your local seller.

#### GENERAL INFORMATION

- Unauthorized repairs or disassembly of the product will void the warranty and may cause its damage.
  - This product is safe and complies to EU requirements.
  - This product is manufactured conforming with the European RoHS standard. This standard was introduced to reduce the amount of electrical and electronic waste emitted into the atmosphere.
  - Using the WEEE symbol (the crossed-out bin) indicates that this product is not household waste.
- When recycling waste properly, you protect the environment and people health. Segregated household waste collection, aids recycle materials and components used for the production of this device. For detailed information about recycling, please contact your retailer or a local authority.

### QUICK INSTALLATION GUIDE

#### Warranty Card

Product Model: \_\_\_\_\_

Product Serial No: \_\_\_\_\_

Date of Purchase: \_\_\_\_\_

Customer Name: \_\_\_\_\_

TEL: \_\_\_\_\_

Address: \_\_\_\_\_

Distributor Name: \_\_\_\_\_

TEL: \_\_\_\_\_

Warranty Card is the important certificate for after-sale service of Marvo products, please keep it safe.

www.marvo-tech.com

## BORN FOR GAMING

