



1500



Owner's Manual



Read all instructions carefully in user manual before operating air purifier.

WELCOME

Thank you for your purchase of the pureAir 1500. This unit has been designed to provide you a cleaner living space with years of low maintenance operation.

TABLE OF CONTENTS

Important Safety Instructions	3
Diagrams	4 - 5
Initial Settings	6
Settings	7
Disassembly/Assembly	8 - 9
Cleaning	10 - 11
Maintenance	12
Troubleshooting	13
Specifications	14
Warranty Information	15

PRODUCT CONTENTS

- | | |
|-----------------------|------------------|
| 1 pureAir 1500 Unit | 1 Owner's Manual |
| 1 Power Cord | 1 DC Adapter |
| 1 Remote with Battery | |

IMPORTANT SAFETY INSTRUCTIONS

WARNINGS



When using electrical appliances, basic precautions should always be followed to reduce the risk of fire, electric shock, and injury to persons.



NEVER operate the unit near a heat source, open flame, flammable/combustible fluids, or sources of liquids.



DO NOT operate the unit unless all parts (including ARC CELL, OZONE PLATE, FILTER ASSEMBLY, and REAR COVER) are properly installed.



The unit should be powered OFF and the POWER CORD disconnected whenever cleaning or servicing.



The unit is not intended for outdoor use.



DO NOT use any product with a damaged cord or plug, or if the product malfunctions, is dropped, or is at all damaged. Keep cord away from heated surfaces.



DO NOT run power cords under carpets or rugs. Arrange the power cord to avoid being tripped over.

CAUTIONS



DO NOT view the ultraviolet light directly when the unit is powered and in operation as it may result in severe eye injury. The lamp is not directly visible when mounted in assembled unit.



DO NOT use AWAY MODE in spaces occupied by human beings or pets. Allow for 2 hours following treatment in AWAY MODE prior to returning. Temporary adverse reactions such as throat irritation, coughing, chest pain, or shortness of breath may be caused by excessive levels of ozone. Check that unit is turned off and further ventilate space prior to returning. If adverse reactions persists, seek medical attention and discontinue use of device.



ARC Cell contains Hg (Mercury) and should be disposed of according to disposal laws. Find disposal centers at www.earth911.org. DO NOT handle if broken or hot.



DO NOT use device in HIGH MODE during planned activity of heavy exertion such as exercising.



DO NOT adjust the square footage setting in to exceed the square footage of the space being treated.



DO NOT block the ventilation or filters.



DO NOT place unit directly facing sitting or sleeping areas.

DIAGRAMS

Unit Front

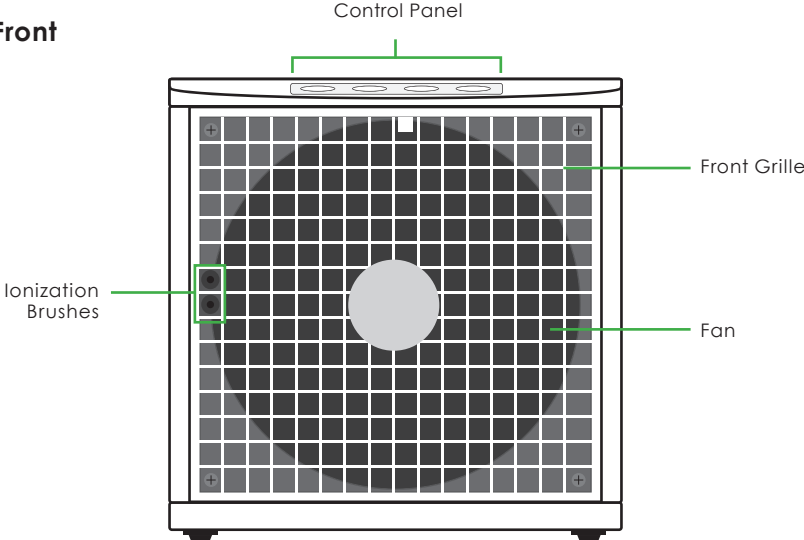

Unit Rear
(Closed)

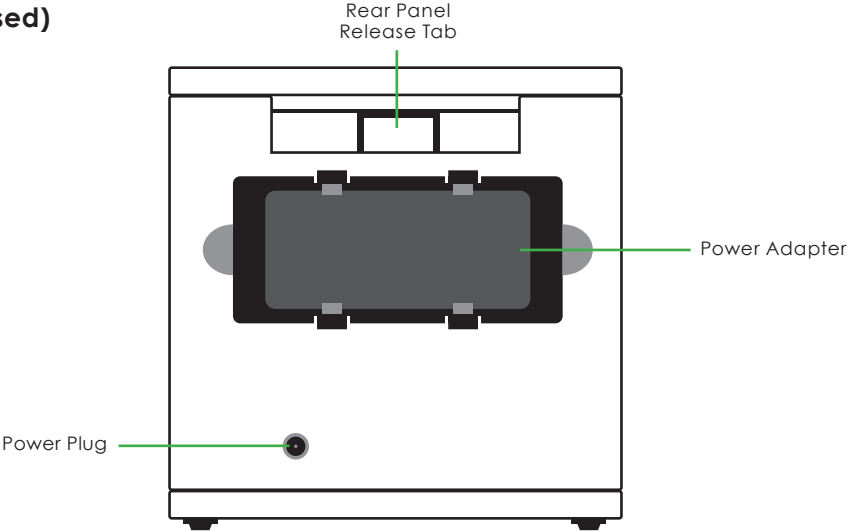

DIAGRAMS

Unit Rear (Open)

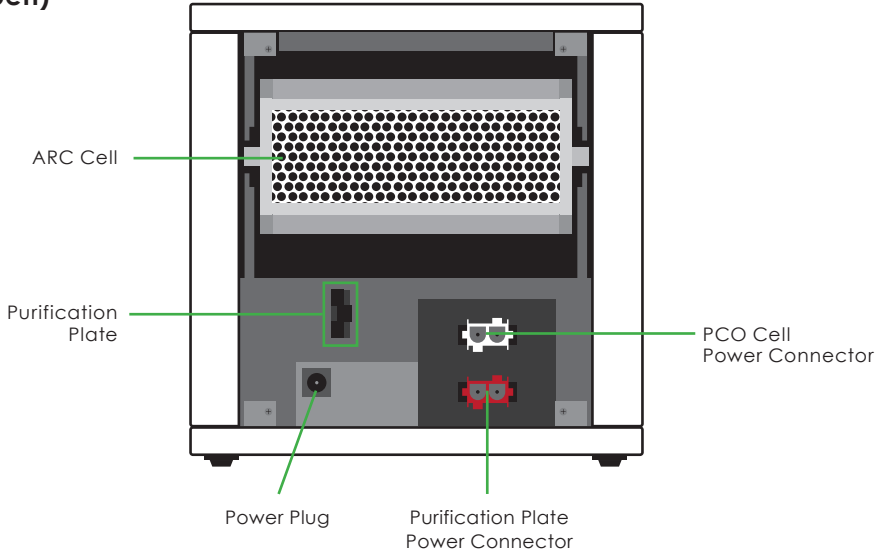

Control Panel

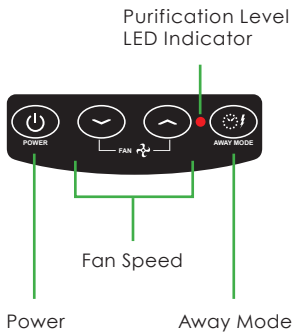

Remote

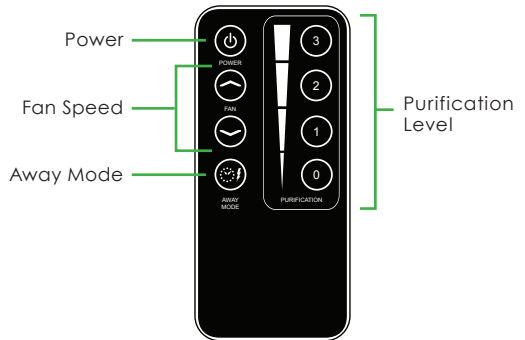

INITIAL SETTINGS

Before using your pureAir 1500 you will need to find the area (or square footage) of the environment. To do this accurately, take into account all connected rooms with open doorways (the purification does not flow through closed doors). The pureAir 1500 can purify up to 1,500 square feet of space (based upon an open floor plan with 8.5' ceilings).

Once you have determined an ideal location for your unit and calculated the area of the environment:

1. Plug the POWER ADAPTER into a wall outlet and then plug the other end into the POWER PORT of your unit.
2. Place the POWER ADAPTER into the open space in the rear of the unit.
3. Leave the unit at it's beginning setting (PURIFICATION LEVEL 0/FAN SPEED HIGH) for at least 24 hours to begin with.
4. Gradually increase the PURIFICATION LEVEL setting every 12 - 24 hours until you reach your desired setting. Use the next page to estimate your purification level based upon your square footage.
5. If you reach your recommended square footage and still notice an unpleasant odor from your space, consider using AWAY MODE for an extra cleaning boost.
(See page 7 for AWAY MODE instructions.)

SETTING UP

1. **Unpack your pureAir 1500**

Remove everything from the box. Check and make sure you have everything listed in "PRODUCT CONTENTS" on page 2. Keep your packaging in case you need to return or exchange your unit. When you are satisfied with your unit, please recycle the box and properly dispose of all other packaging materials.

2. **Select a location for your pureAir 1500**

There are several things to consider when selecting a location. First, find a common room that contains an HVAC return or adjoining a hallway that has an HVAC return. Ideally, locate the unit within twelve to twenty four inches (12"-24") of the ceiling, on a bookcase, shelf, or mounting bracket. Make sure that there is nothing within three inches (3") of the rear of the unit for proper air flow. Point the unit towards the center of the room. Never place an operating unit on the floor.

3. **Place your pureAir 1500 and plug it in**

Check to make sure your unit is secure. Falling units can cause serious headaches! Unravel the cord attached to your DC POWER ADAPTER and your POWER CORD. Plug the DC POWER ADAPTER PLUG into the rear of the unit, then plug the POWER CORD into the wall. Make sure the POWER CORD is securely seated in the DC POWER ADAPTER and that the green indicator light on the DC POWER ADAPTER is lit, showing that it properly connected.

SETTINGS

There are multiple ways to change the output of your unit. If you need the unit to be quieter, change the Fan Speed, if you need a larger or smaller area covered, change the Purification Level, and if you need a tough odor removed, use Away Mode.

Fan Speed

Three fan speeds are available (Low, Medium, High) and are adjusted with the FAN UP/DOWN buttons on both the machine's CONTROL PANEL as well as with the REMOTE.

Purification Level

Purification level is controlled on the REMOTE and adjusts the output of Activated Oxygen (O₃). Four levels are available and will be signified by varying colors on the CONTROL PANEL.

LEVEL 0 (0 - 250ft²): LED is OFF.



(Level 0 uses only ARC® and Ionization Technology.)

LEVEL 1 (250 - 500ft²): LED is GREEN

LEVEL 2 (500 - 1000ft²): LED is YELLOW

LEVEL 3 (1000 - 1500ft²): LED is RED

Away Mode

Away Mode is used to treat the toughest odors in your space with higher levels of Activated Oxygen and Ionization. To activate, press the AWAY MODE BUTTON on the CONTROL PANEL or REMOTE.



DO NOT use AWAY MODE in spaces occupied by human beings or pets. Allow for 2 hours following treatment in AWAY MODE prior to re-entering. Temporary adverse reactions such as throat irritation, coughing, chest pain, or shortness of breath may be caused by excessive levels of ozone. If irritation occurs, check that unit is turned off and further ventilate space prior to returning. If adverse reaction persists, seek medical attention and discontinue use of device.

Away Mode is active for 2 Hours before reverting back to previous settings.

DISASSEMBLY



The unit should be powered OFF and the POWER CORD disconnected whenever cleaning or servicing.



Refer to the Diagram Section (Pg. 4-5) for further illustrations of part names and locations.

Rear Cover

After unplugging and removing the POWER CORD and POWER ADAPTER, press down on the tab above the POWER ADAPTER space and then pull back on the REAR COVER.

Side Filters

After removing the REAR COVER, slide each of the FILTER ASSEMBLIES straight out. These separate and contain 3 different filter pieces.

Purification Plate

(a) Locate the PURIFICATION PLATE CONNECTOR (Red Connector Piece) on the right side of the unit. Squeeze the tabs on the left and right and gently pull free. **(b)** Grasp the PURIFICATION PLATE, press the tabs towards the middle and slide it out of its slot.

ARC® Cell



ARC Cell contains Hg (Mercury) and should be disposed of according to disposal laws. Find disposal centers at www.earth911.org. DO NOT handle if broken or hot.

(a) Locate the ARC CELL CONNECTOR (White Connector Piece) on the right side of the unit. Squeeze the tabs on the left and right and gently pull free. **(b)** Grasp the ARC CELL, and gently pull back to remove it from the slot.

Front Grille

Locate and remove the four FRONT GRILLE SCREWS in the four corners of the FRONT GRILLE using a #1 Phillips Head Screwdriver. Place the screws where you will find them again easily. Remove the FRONT GRILLE carefully to ensure the IONIZATION BRUSH is not damaged.

ASSEMBLY



The unit should be powered OFF and the POWER CORD disconnected whenever cleaning or servicing.



All parts must be properly installed before operating the unit. Failure to do so may damage the unit.



Refer to the Diagram Section (Pg. 4-5) for further illustrations of part names and locations.

Front Grille

Replace the FRONT GRILLE and the four FRONT GRILLE SCREWS using a Phillips Head Screwdriver. Be careful to not over-tighten the screws or damage the IONIZATION BRUSH.

ARC® Cell



ARC Cell contains Hg (Mercury) and should be disposed of according to disposal laws. Find disposal centers at www.earth911.org. DO NOT handle if broken or hot.

(a) Slide the ARC CELL back into the upper slot with the warning at the top, facing out.

(b) Plug the ARC CELL CONNECTOR back into the WHITE CONNECTOR SLOT.

Purification Plate

(a) Slide the PURIFICATION PLATE back into the small slot with the larger silver side facing to the left. **(b)** Plug the PURIFICATION PLATE CONNECTOR back into the RED CONNECTOR SLOT.

Side Filters

Ensure that the FILTER ASSEMBLIES are snapped together correctly, then replace the SIDE FILTERS in each of the side slots with the rounded edges facing outwards.

Rear Cover

Place the REAR COVER bottom edge into the hinge slot then push forwards until the tab clicks.

Power Cord

Insert the POWER ADAPTER into the rear slot and then replace the POWER CORD in the POWER PORT.

CLEANING

For proper operation, the unit should be cleaned at least once per month.



Turn the unit OFF and remove the POWER CORD before performing any cleaning or maintenance to prevent injury.



Refer to the Disassembly and Assembly Sections (Pg. 8-9) before performing any cleaning and maintenance to prevent damage to the unit.

Unit Exterior

Wipe down the exterior with a damp cloth or use compressed air or a vacuum cleaner to remove dust. A non-abrasive cleaner may be used on the surfaces of the exterior.

Filter Assembly

Clean water or compressed air may be passed through the entire filter assemblies or the individual parts when disassembled. To disassemble the FILTER ASSEMBLIES grasp the sides of the rim and carefully separate the back piece from the housing. The three filters [mesh, foam, honeycomb] can then be removed and cleaned separately. If using water you must allow the filters to fully dry before reassembly. When reassembling, the HONEYCOMB FILTER goes in first, then the FOAM FILTER, and finally the thin MESH FILTER. Then simply reattach the rear piece to the housing.

CLEANING



The unit should be powered OFF and the POWER CORD disconnected whenever cleaning or servicing.



All parts must be properly installed before operating the unit. Failure to do so may damage the unit.



Refer to the Dissassembly and Assembly Sections (Pg. 8-9) before performing any cleaning and maintenance to prevent damage to the unit.

Unit Interior

Using a damp cloth, a clear alcohol based cleaner, or compressed air/vacuum cleaner carefully clean the walls and components inside of the unit, after completing the DISASSEMBLY procedures.

ARC® Cell



ARC Cell contains Hg (Mercury) and should be disposed of according to disposal laws. Find disposal centers at www.earth911.org. DO NOT handle if broken or hot.

Using compressed air or a vacuum blow/suck the dust out of the ARC Cell. Do not use any liquid to clean the ARC Cell.

Purification Plate

The Purification Plate only needs cleaning every 3 months, unless it is used in a harsh environment (Smoking Area, Kitchen, Pet Area).

Using a 50/50 mix of warm water and clear ammonia, soak the PURIFICATION PLATE from 1-8 hours. Using a soft-bristle brush, scrub the metal center. Rinse thoroughly and allow to dry completely before reinstalling.

MAINTENANCE



The unit should be powered OFF and the POWER CORD disconnected whenever cleaning or servicing.



All parts must be properly installed before operating the unit. Failure to do so may damage the unit.



Refer to the Dissassembly and Assembly Sections (Pg. 8-9) before performing any cleaning and maintenance to prevent damage to the unit.

General Maintenance

Your unit should need little to no maintenance, besides an occasional ARC Cell or Purification Plate Replacement, but sometimes problems arise. If you can't find a resolution in the Troubleshooting Section (Pg. 13) contact GreenTech Environmental for further instructions. (www.GreenTechEnv.com)

ARC® Cell Replacement



ARC Cell contains Hg (Mercury) and should be disposed of according to disposal laws. Find disposal centers at www.earth911.org. DO NOT handle if broken or hot.

The ARC CELL does wear out and should be replaced yearly to ensure a high level of efficient cleaning. A replacement can be bought through your Dealer or GreenTech Environmental. (www.GreenTechEnv.com)

Purification Plate Replacement

The PURIFICATION PLATE does not wear out as often and will only need to be replaced every 2-3 years of constant use; earlier if you have a harsh environment. A replacement can be bought through your Dealer or GreenTech Environmental. (www.GreenTechEnv.com)



Purification Plate



ARC Cell

TROUBLESHOOTING



The unit should be powered OFF and the POWER CORD disconnected whenever cleaning or servicing.

Unit Fails to Turn On

1. Check to make sure that the POWER PLUG, POWER CORD, and POWER ADAPTER are all properly connected.
2. Verify that the POWER BUTTON has been activated on the CONTROL PANEL

If further problems persist, contact GreenTech Environmental (www.GreenTechEnv.com) for further instructions or replacement.

Unit is Operating in High or Away Mode, but no Noticeable Purification is Being Produced

1. Ensure that the PURIFICATION PLATE is clean and that its CONNECTOR is fully inserted.
2. View the unit operating in a dark room through the FRONT GRILLE. The PURIFICATION PLATE should have a dim purple glow.

If further problems persist, contact GreenTech Environmental (www.GreenTechEnv.com) for further instructions or replacement.

The Purification Plate Generates an Electrical Arc, Arcing Noise, or Burning Odor

The PURIFICATION PLATE is damaged and must be replaced. Contact GreenTech Environmental for replacement. (www.GreenTechEnv.com)

The ARC® Cell is Not Lighting Up



ARC Cell contains Hg (Mercury) and should be disposed of according to disposal laws. Find disposal centers at www.earth911.org. DO NOT handle if broken or hot.

1. Ensure that the ARC CELL CONNECTOR is properly inserted into its slot.

If further problems persist, contact GreenTech Environmental (www.GreenTechEnv.com) for further instructions or replacement.

Ionization Needle Creates an Electrical Arc

The IONIZATION NEEDLE needs to be cleaned. Be sure to complete all of the cleaning procedures in the Cleaning Section (Pg. 10-11) every 30 days.

Fan Does Not Operate Properly

1. Try adjusting the FAN SPEED using the CONTROL PANEL or REMOTE CONTROL.
2. Remove the FRONT GRILLE and ensure there are no obstructions to the movement of the FAN. Clean it thoroughly and also clean the mount that it sits on.

If further problems persist, contact GreenTech Environmental (www.GreenTechEnv.com) for further instructions or replacement.

SPECIFICATIONS

Input Voltage 100 - 240VAC | 50/60Hz | 2.5A

Output Voltage 15V DC 3A

Power Consumption.....21W

Unit Dimensions.....6.75'' H x 6.50'' W x 7.00'' D
.....(172mm H x 165mm W x 178mm D)

Unit Weight 3 lb
..... (1.36 kg)

Activated Oxygen (O₃) Output

Purification Plate25 - 360 mg/hr
ARC® Cell..... No Ozone

Ionization Output6 KV DC Needle Ion Generator
..... .24 - 30 KV, 20 - 30 Khz Ion Generation Pulsator

Effective Area Up to 1500 ft² (Open Floor - 8.5' Ceilings)

Warranty 1 Year Manufacturer's Warranty

WARRANTY INFORMATION

Your pureAir 1500 is warranted to be free from all defects in material and workmanship in normal household use for a period of **1 Year** from date of purchase. The warranty is granted only to the original purchaser and members of his or her immediate household. The warranty is subject to the following provisions. Any damages or malfunctions caused by negligence, abuse, or use not in accordance with the Owner's Manual are not covered by this warranty. Likewise, any defects or damages caused by unauthorized service are not covered. GreenTech Environmental will, at its option, repair or replace a defective unit that is covered by this warranty. As a matter of warranty policy, GreenTech Environmental will not refund the customer's purchase price. To obtain warranty service you must return the defective unit along with proof of purchase to the pureAir Authorized Warranty Station. All transportation charges on parts, or units, submitted under this Warranty shall be borne by purchaser. Unless this Warranty is expressly renewed or extended by GreenTech Environmental, any repaired or replaced part of unit shall be warranted to the original purchaser only for the length of the unexpired portion of the original warranty.

FURTHER LIMITATIONS AND EXCLUSIONS ARE AS FOLLOWS:

Any warranty that may be implied in connection with your purchase or use of the unit, including any warranty of merchantability or any warranty for Fitness For A Particular Purpose is limited to the duration of this warranty. Some states do not allow limitations on how long an implied warranty lasts, so the above limitations may not apply to you.

Your relief for the breach of this warranty is limited to the relief expressly provided above. In no event shall GreenTech Environmental be liable for any consequential or incidental damages you may incur in connection with your purchase or use of the Unit. Some states do not allow the exclusion or limitation of incidental or consequential damages, so the above limitation or exclusion may not apply to you.

This warranty gives you specific legal rights, and you may also have other rights which vary from state to state.

REGISTRATION

Please register your new pureAir product within 10 days of purchase by visiting:

www.GreenTechEnv.com/Warranty



OM Revision: GTE-pureAir_1500-OwnersManual-210106

www.GreenTechEnv.com