

 AVI_8

For more details on operating this timepiece please refer to the enclosed booklet or visit:

AVI-8.COM



AVI-8

**HAWKER
HURRICANE**

CAREY DUAL TIME

For more information
Pour plus d'informations
Para más información
Per maggiori informazioni
Für mehr Informationen
想要查询更多资讯
詳細については



**Instruction Manual
Vol. 1.88B EN**

AV-4088

MULTI-FUNCTION WATCH

This watch is equipped with a unique multi-function feature with a second time zone read out and a 24 hour display feature.

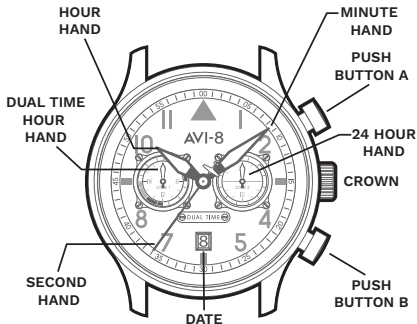

For more details on operating this timepiece please refer to the enclosed booklet or visit:

AVI-8.COM

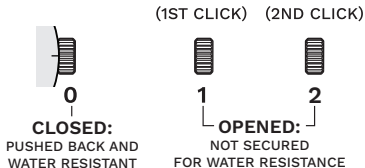

HOW TO SET THE TIME

1. Pull out the crown to the position [2]-(2nd click).
2. Turn the crown to set the hour and minute hands.
3. Push the crown back to position [0].

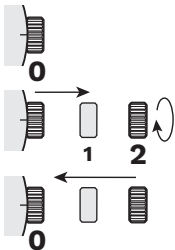

* The 24 hour hand moves correspondingly with the hour hand.

* The moment of the date changes is midnight. When setting the hour hand, make sure that AM/PM is correctly set by using the 24 hour hand as an AM/PM indicator.

HOW TO SET THE SECOND TIME ZONE

When staying in a place that is in a different time zone from where you usually use this watch, you can set the dual time hour hand to indicate the local time of the place where you are staying.

QUICK SETTING OF THE SECOND TIME ZONE

1. Keep the crown at position [0].
2. Press Push Button A or B to set the dual time hour hand to indicate the local time of the place where you are staying.

- Button A : - 1 hour / push

- Button B : + 1 hour / push

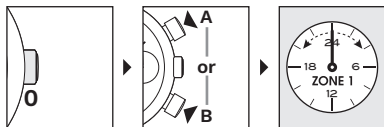

+/-1 Hour / Push

PRECISE ADJUSTMENT OF THE SECOND TIME ZONE

1. Pull the crown at position [2]-(2nd click) when the second hand is at 12 o'clock.
2. Press Push Button A or B to set the dual time hour hand to indicate the local time of the second time zone.

Button A : - 10 minute / push

Button B : + 10 minute / push

3. Push the crown back to position [0].

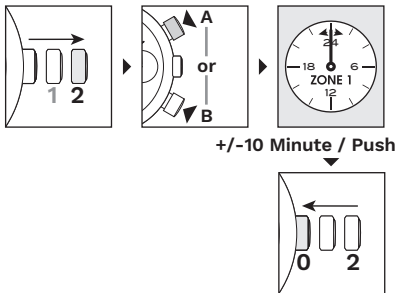

HOW TO SET THE DATE

1. Before setting the date, be sure to set the time.
2. Pull out the crown to the position [1]-(1st click).
3. Turn the crown clockwise. The date will advance 1 day when the time reaches 00:00 midnight. Continue to turn the crown for the desired date.
4. After setting, push the crown back to position [0].

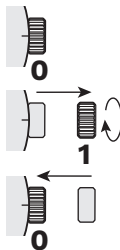

NOTE :

- * It is necessary to adjust the date on the first day after a 30-day month and February.
- * Do not set the date between 9:00 P.M. and 1:00 A.M., as the date may not change properly. If it is necessary to set the date during that period of time, first change the time to any time outside of this period, set the date, and then reset to the correct time.

HOW TO USE A DEPLOYANT CLASP

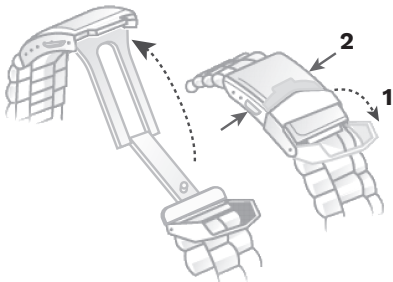

1. Flip the cover.
2. Press the buttons on the clasp sides.

HOW TO RESIZE METAL BRACELET

On the inside of the bracelet, you will see some small arrows engraved on removeable links.

1.

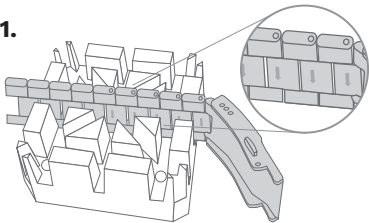

2.

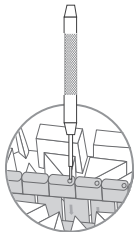

9

3.

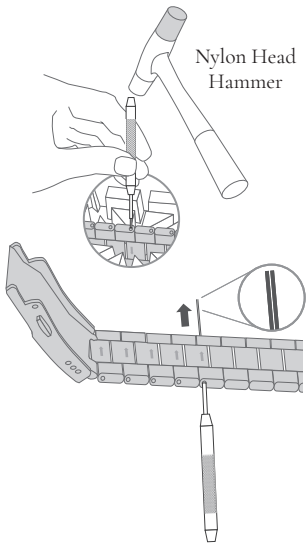

4.

10

5.

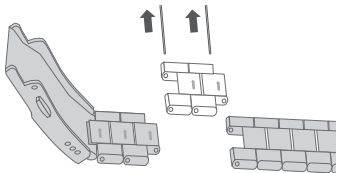

6.

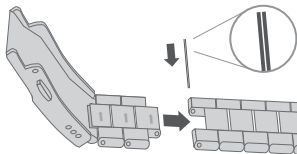

7.

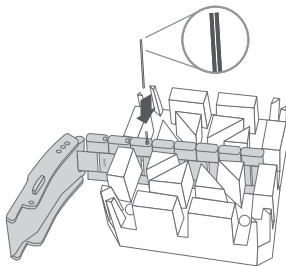

8.

Nylon Head
Hammer

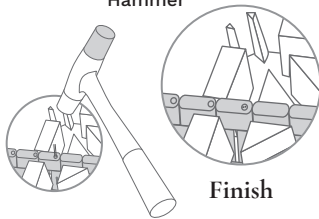

9.

Micro size
adjustment

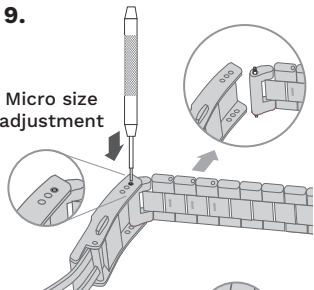

10.

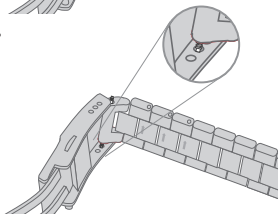

11.

12.

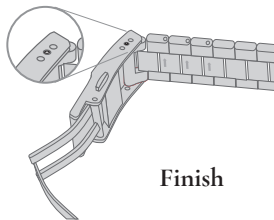
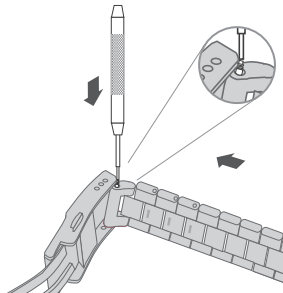



Finish

WATER RESISTANCE

Note that the water resistance chart serves only as a guide (please refer to the water resistance chart on the next page). Actual water resistance may vary depending on a number of factors including water temperature, water salinity and use under water. The water resistance of your timepiece may eventually be compromised over time with general wear and tear and use of your timepiece under adverse conditions.

Note that you should **NEVER** wear your watch in a jacuzzi, hot shower or steam room where steam may enter the case despite the watertight seals used to protect your watch. This may cause condensation inside your watch, which may affect and damage the inner workings of your watch.

WATER RESISTANCE CHART	50M/ 5ATM
SPLASH/ SHOWERING	
SWIMMING/ BATHING	
BRIEF SWIMMING/ WATER SPORTS	
PROLONGED SWIMMING/ FREE DIVING	
SCUBA DIVING	
PROFESSIONAL DEEP SEA DIVING	

Represented By:
Authorised Rep Compliance Ltd.,
Ground Floor, 71 Lower Baggot Street,
Dublin, D02 P593, Ireland.

WARNING

- **INGESTION HAZARD:** This product contains a button cell or coin battery.
- **DEATH** or serious injury can occur if ingested.
- A swallowed button cell or coin battery can cause **Internal Chemical Burns** in as little as **2 hours**.
- **KEEP** new and used batteries **OUT OF REACH** of **CHILDREN**.
- **Seek immediate medical attention** if a battery is suspected to be swallowed or inserted inside any part of the body.



**CE UK
CA**